

## PICNIC SETTING

Designer: SPARK - Cameron Johnston



Available in a DDA compliant version

### SLAT OPTIONS

- Oiled hardwood
- Composite
- Clear anodised aluminium
- Wood grain aluminium

### FRAME OPTIONS

- Hot dip galvanised mild steel

### FRAME FINISHES

- Galvanised
- Powdercoated

### INSTALLATION

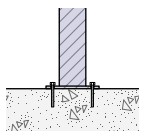

Bolt Down

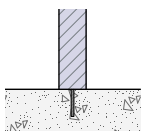

Concealed Fix

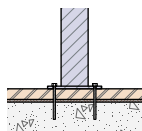

Bolt Through

### FIXINGS

- 12mm fixings for 14mm diameter holes

Alternative materials and finishes available on request

# GEMTREE PICNIC SETTING

## SPECIFICATIONS

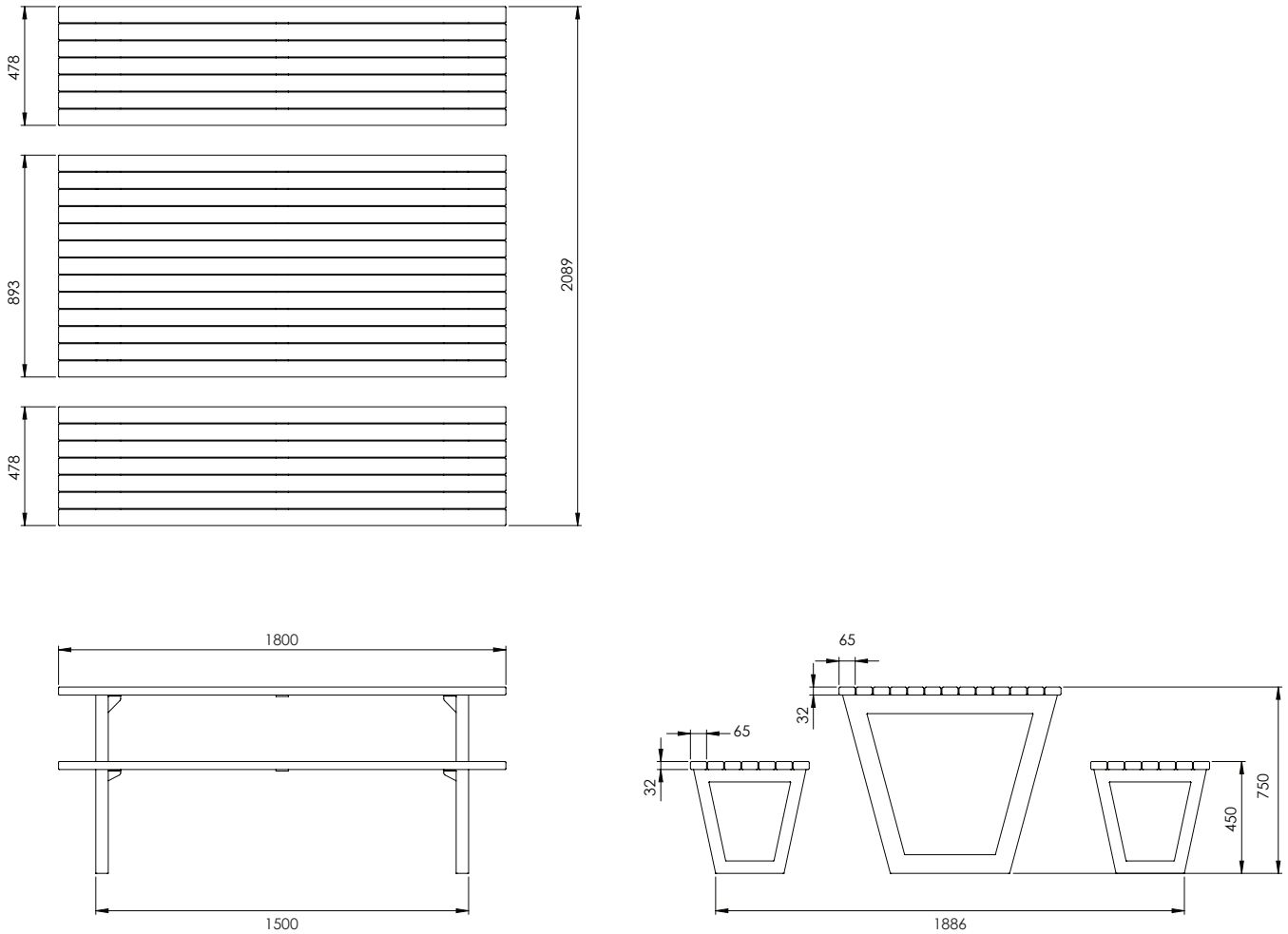

All measurements are in millimetres.. Drawings are not to scale.  
Dimensions shown are for timber slat option.

PRODUCT CODE	FRAME FINISH	SLAT OPTION & SIZE (mm)
GMT006-HDG-GV-T	Galvanised	65x32 Oiled hardwood timber
GMT006-HDG-GV-C	Galvanised	60x40 Composite
GMT006-HDG-GV-A	Galvanised	65x35 Clear anodised aluminium
GMT006-HDG-GV-W	Galvanised	65x35 Wood grain aluminium
GMT006-HDG-PC-T	Powdercoated	65x32 Oiled hardwood timber
GMT006-HDG-PC-C	Powdercoated	60x40 Composite
GMT006-HDG-PC-A	Powdercoated	65x35 Clear anodised aluminium
GMT006-HDG-PC-W	Powdercoated	65x35 Wood grain aluminium